

# LD47 & LD48



Low Glare Tilted Interior/Exterior Wall or Step lights

Data sheet - Page 1



Design: Light IQ Project: Private Residence Product: LD47

Available in round or square the LD47/48 will fit into most architectural styles. The lens assembly is set back and inclined by 20° for a floor wash illumination and minimal glare. Manufactured with a machined stainless steel 316 bezel and black anodized body these can be used for indoor and outdoor use.

## Key Features

- LED and lens assembly recessed and tilted by 20° within a black anodised body for reduced glare
- High quality machined bezel and body
- Square and round versions available
- Glass fixed with hidden gasket, so no unsightly glue line
- No visible fixings. Options include spring fixing clips or O-rings and a first fix sleeve
- Can be used for external and internal applications
- Integral anti-wicking barrier increases protection against moisture ingress due to incorrect IP rated cable connections
- Range of bezel finish options including stainless steel and paint finishes
- Available with Switch, 0-10V, DMX, Dali or Mains dimmable drivers

## Specification

Applications						
Beam Angles	12°, 31°, 48°					
LED type	1 x Cree XPG2					
Colour temperature	2700K** / 3000K			5000K		
Drive Current (mA)	350	500	700	350	500	700
LED power* (W)	1.2W	1.7W	2.4W	1.2W	1.7W	2.4W
CRI (typical)	93	93	93	75	75	75
Forward voltage (V) <sub>100</sub>	3.0V	3.2V	3.4V	3.0V	3.2V	3.4V
Delivered lumens** (L <sub>100</sub> )	93	127	167	113	154	206
Lumens per circuit watt	78	75	70	94	91	86
LED lifetime (to 70% lumen maintenance)	50,000hrs at a max ambient temperature of 35°C (if specifying fitting in ambient temperatures of up to 45°C run at 500mA max, LD47/48-500)					
Materials	Black anodised aluminium body, Machine finish 316 stainless steel bezel (other options available)					
Glass	5mm thick borosilicate					
Wiring	Comes pre-wired with 2 core 100mm lead, can be specified with up to 10m at extra cost					
IP rating	IP67					

LD47

LD48



\*LED wattage includes losses associated with using an 85% efficient driver  
 \*\* 2700K lumen output is 12% lower than the 3000K figure listed  
 4000K lumen output is 14% higher than the 3000K figure listed (80 CRI)

# LD47 & LD48



Low Glare Tilted Interior/Exterior Wall or Step lights

Data sheet - Page 2

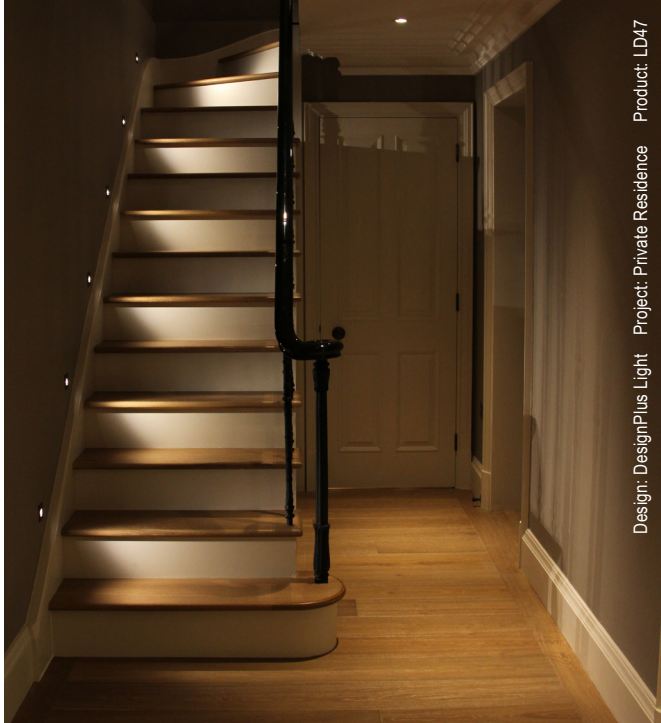

## Photometrics

Photometric files are included in the design pack which can be downloaded from the LD45 & LD46 product page on the website.

## Order Codes and Options

Product code	LED colour	Lens angle	Finish	Fixing
LD47/48- 350 - 500 - 700	<input type="text"/>	<input type="text"/>	<input type="text"/>	<input type="text"/>

Example: LD47-700 / LW30 / MB / Stainless steel / 477

### Product codes with output options

1.2W LED at 350mA	LD47-350, LD48-350
1.7W LED at 500mA	LD47-500, LD48-500
2.4W LED at 700mA	LD47-700, LD48-700

### LED colour options

LED colour options	Suffix
Super Warm White (2200K)	/LW22
Extra Warm White (2700K)	/LW27
Warm white (3000K)	/LW30
White (4000K) - on request	/LW40
Cool White (5000K)	/LW50
Blue	/LB
Green	/LG
Red	/LR
Amber	/LA

\*Other LED colour temperatures are available. Please speak to a member of our sales team.

### Beam / lens angle options

12° narrow spot	/NB
31° medium	/MB
48° wide	/WB

### Bezel finish options

Stainless steel 316  
Polished and passivated stainless steel (for marine environments)  
Flamed solid bronze (antique finish)  
Paint finish silver / white / black / RAL (not suitable for high traffic areas)

\*See our finishes guide for other options

### Fixing options

Spring clips	/SC
First fix sleeve and O-rings	/477

### Use with 350mA, 500mA or 700mA constant current LED drivers

We have a wide range of dimmable LED drivers, 0-10V, DMX, DALI and Mains dimmable. Please see the downloads section on our website:

To run 1-14 LD47/LD48-350 in series use a TXDEL350D (0-10V dimmable)

To run 1-14 LD47/LD48-500 in series use a TXDEL500D (0-10V dimmable)

To run 1-13 LD47/LD48-700 in series use a TXDEL700D (0-10V dimmable)

## Dimensions and Fixing Options

### /SC - Spring clip fixing

Useful for most wall mounted applications

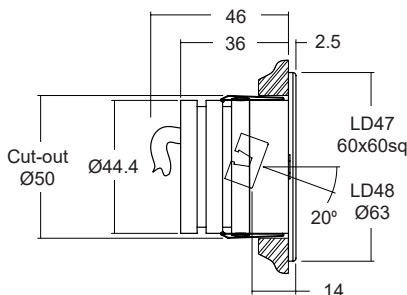

### /477 - 'O' rings and sleeve

A more robust and water tight method of fixing, for wet areas

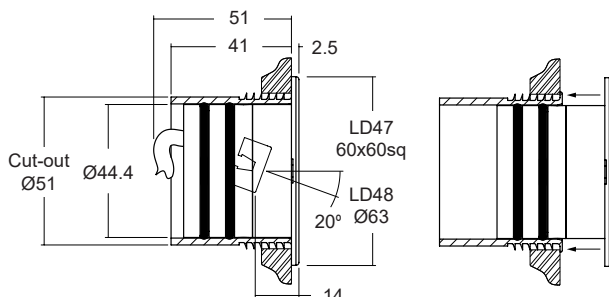

(Dimensions in mm)